

419-898-3305



C. NELSONMFG .. www.cnelson.com
265 N. LAKE WINDS PKWY.,
OAK HARBOR, OH 43449
419-898-43305 X 201 sales@cnelson.com

Custom Mobile Scooping Carts

Nelson Mobile scooping carts are designed for use ANYTIME or ANYWHERE

The mobile carts shown on these pages are the most common configurations we produce. If you don't see what you want, just ask.

Links to NSF and ETL showing our listings, if needed for your local health department, can be seen on our website,

We at Nelson do not simply buy an inexpensive store freezer and turn it into an outdoor cart. We build our carts from the ground up in Oak Harbor, Ohio, and build them to last and perform in the heat of the outdoor summers.

Our sink systems are approved by NSF, LA County and Clark County, Nevada. Should you need specific information for those locales, Call or e-mail.

Our ice cream, Italian Ice or Gelato carts can be made with stainless steel flip lids (recommended for outdoor use) or with an open-top as a visual dipping cabinet. While we recommend the stainless steel flip lids for outdoor use, the visual display model can come with optional sliding lids that will help the ice cream freezer hold temperature outdoors, and is easily added or taken off to suit the conditions. For instance, the same cart can be used as a visual display ice cream dipping cart in a sports arena or convention center or the sliding lid set can be added for use outdoors if conditions require.

With a digital temperature control, standard on all dipping carts, you can easily use the same cart for a wide variety of products, from the warmer temperatures of soft frozen water ices or Italian ice, to gelato, or ice cream products requiring temperatures of -20 degrees or colder. The digital temperature control allows for the precise setting of the temperature 1 degree at a time.



BD8CE-06



BD6CE-05



BD8DIPCE-01



BD4DIPCE-00+

C. NELSON MFG
265 N. LAKE WINDS PKWY
OAK HARBOR, OH 43449
www.cnelson.com, sales@cnelson.com

Nelson Mobile scooping carts are designed for use ANYTIME or ANYWHERE. The mobile carts shown on these pages are the most common configurations we produce. If you don't see what you want, just ask.

Links to NSF and ETL showing our listings, if needed for your local health department, can be seen on our website. <https://www.cnelson.com/resources/industry-links>.

We at Nelson do not simply buy an inexpensive store freezer and turn it into an outdoor cart. We build our carts from the ground up in Oak Harbor, Ohio, and build them to last and perform in the heat of the outdoor summers. Our sink systems are approved by NSF, LA County and Clark County, Nevada. Should you need specific information for those locales, Call or e-mail.

Our ice cream, Italian Ice or Gelato carts can be made with stainless flip lids (recommended for outdoor use) or with an open-top as a visual dipping cabinet. While we recommend the stainless flip lids for outdoor use, the visual display model can come with optional sliding lids that will help the ice cream freezer hold temperature outdoors, and is easily added or taken off to suit the conditions. For instance, the same cart can be used as a visual display ice cream dipping cart in a sports arena or convention center or the sliding lid set can be added for use outdoors if conditions require.

With a digital temperature control, standard on all dipping carts, you can easily use the same cart for a wide variety of products, from the warmer temperatures of soft frozen water ices or Italian ice, to gelato, or ice cream products requiring temperatures of -20 degrees or colder. The digital temperature control allows for the precise setting of the temperature 1 degree at a time.

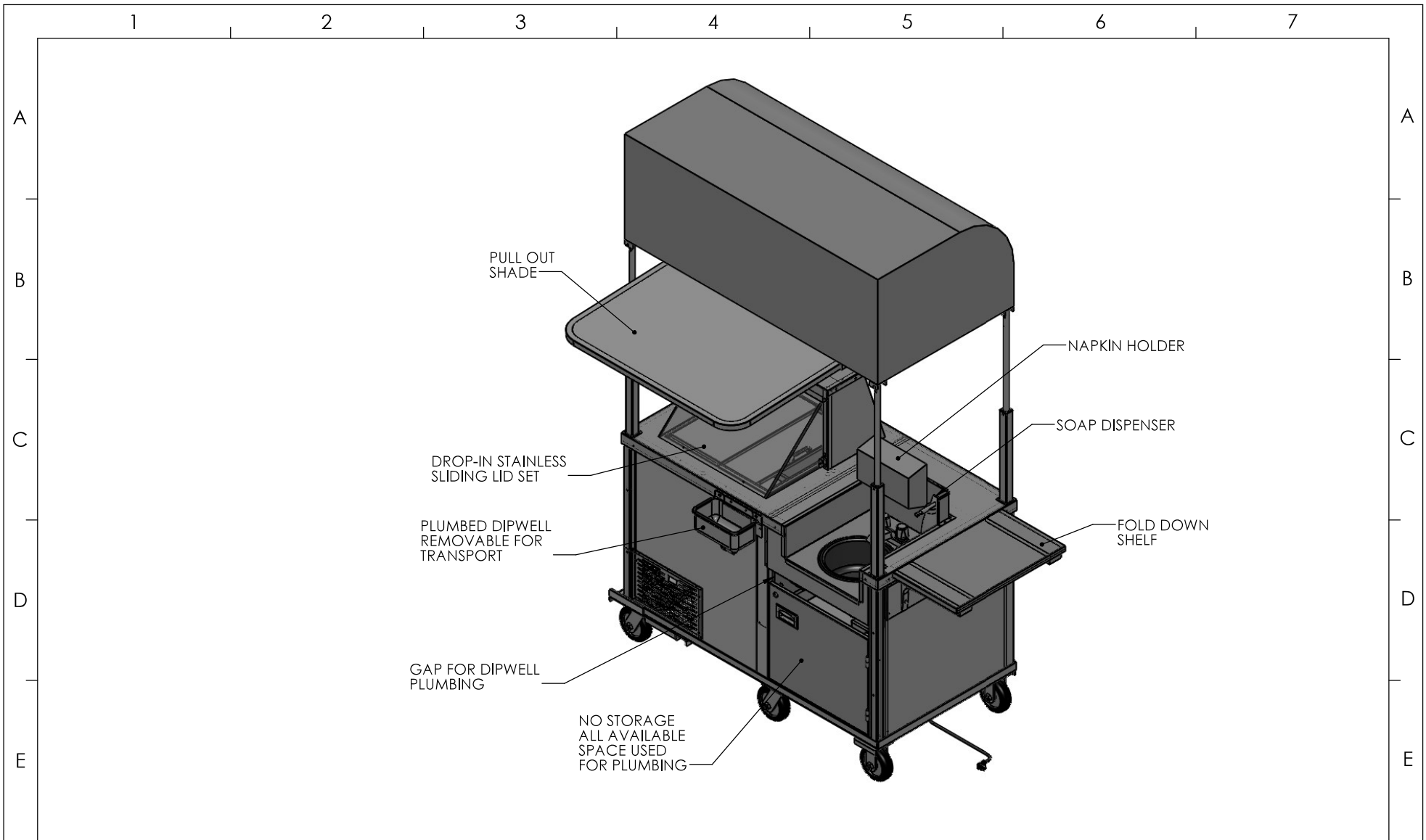

C. Nelson Mfg.

DWG. NO.
795 - BD4CE-DIP-03 WITH DIP WELL

TITLE:
**BD4CE-DIP-03 WITH
EXTERNAL DIPWELL**

SIZE B	REV -	SHEET 1 OF 2	SCALE: 1:15
------------------	-----------------	--------------	-------------

	NAME	DATE	USED ON
DRAWN	PAC	06/07/21	795
CHECKED			
COMMENTS: -			

PROPRIETARY AND CONFIDENTIAL

THE INFORMATION CONTAINED IN THIS DRAWING IS THE SOLE PROPERTY OF C. NELSON MFG. ANY REPRODUCTION IN PART OR AS A WHOLE WITHOUT THE WRITTEN PERMISSION OF C. NELSON MFG. IS PROHIBITED.

DO NOT SCALE DRAWING

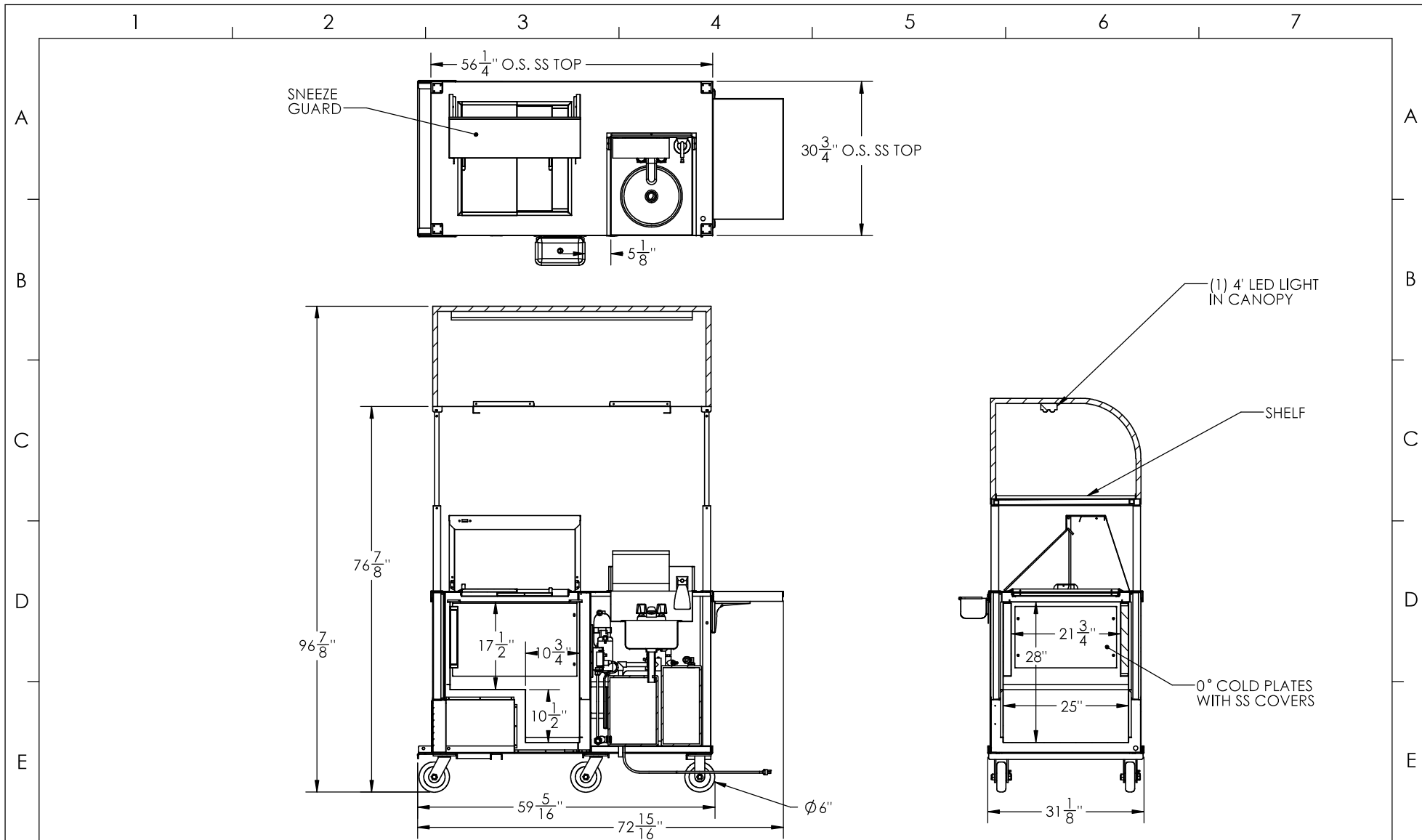

C. Nelson Mfg.

DWG. NO.
795 - BD4CE-DIP-03 WITH DIP WELL

TITLE:

**BD4CE-DIP-03 WITH
EXTERNAL DIPWELL**

	NAME	DATE	USED ON
DRAWN	PAC	06/07/2021	795
CHECKED			
COMMENTS:			
-			

SIZE	REV	SHEET	SCALE
B	-	2 OF 2	1:18

PROPRIETARY AND CONFIDENTIAL

THE INFORMATION CONTAINED IN THIS DRAWING IS THE SOLE PROPERTY OF C. NELSON MFG. ANY REPRODUCTION IN PART OR AS A WHOLE WITHOUT THE WRITTEN PERMISSION OF C. NELSON MFG. IS PROHIBITED.

DO NOT SCALE DRAWING

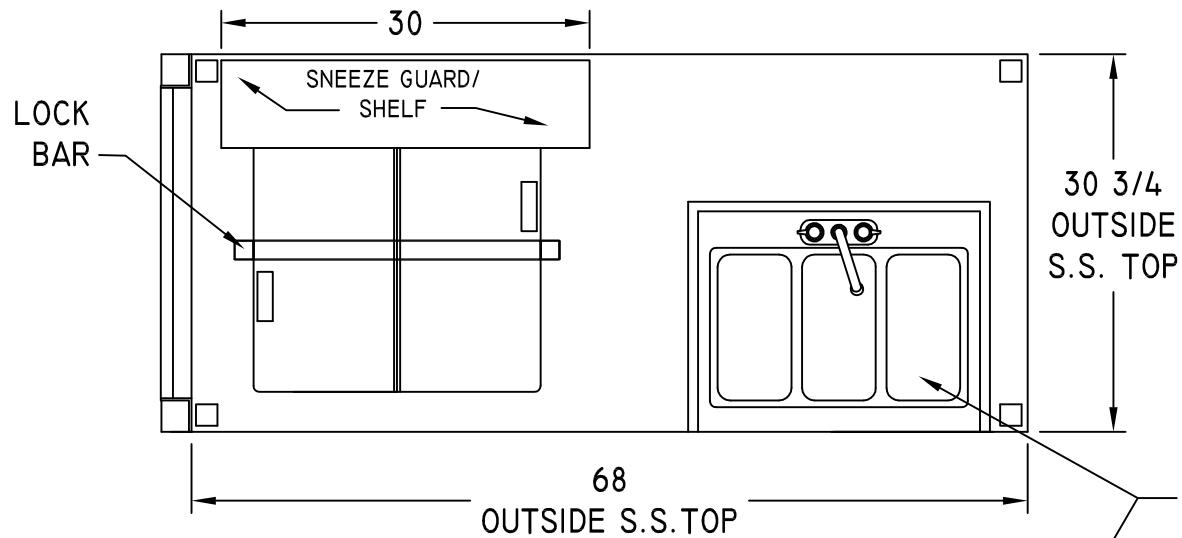

LABEL	DIM. WITH COLD PLATE	DIM. W/O COLD PLATE
A	24 $\frac{1}{4}$	25 $\frac{3}{4}$
B	10 $\frac{3}{4}$	10 $\frac{3}{4}$
C	22	25

MEETING HEALTH DEPARTMENT
REQUIREMENTS ARE THE
RESPONSIBILITY OF THE CUSTOMER

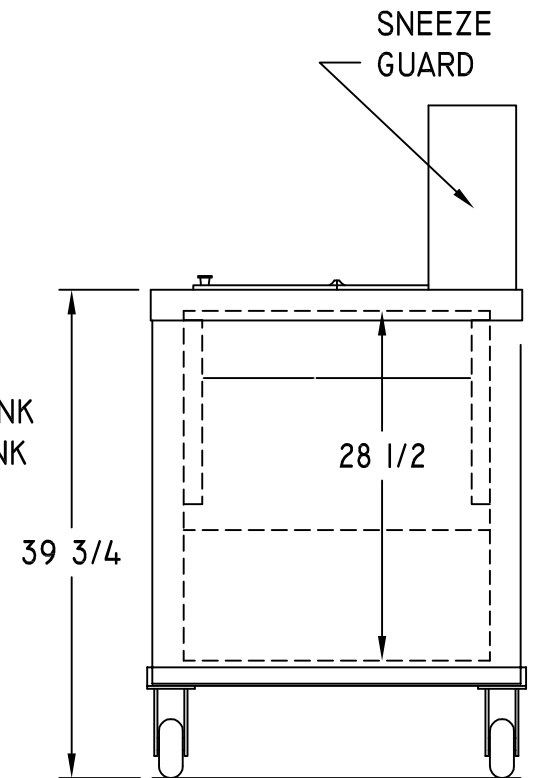
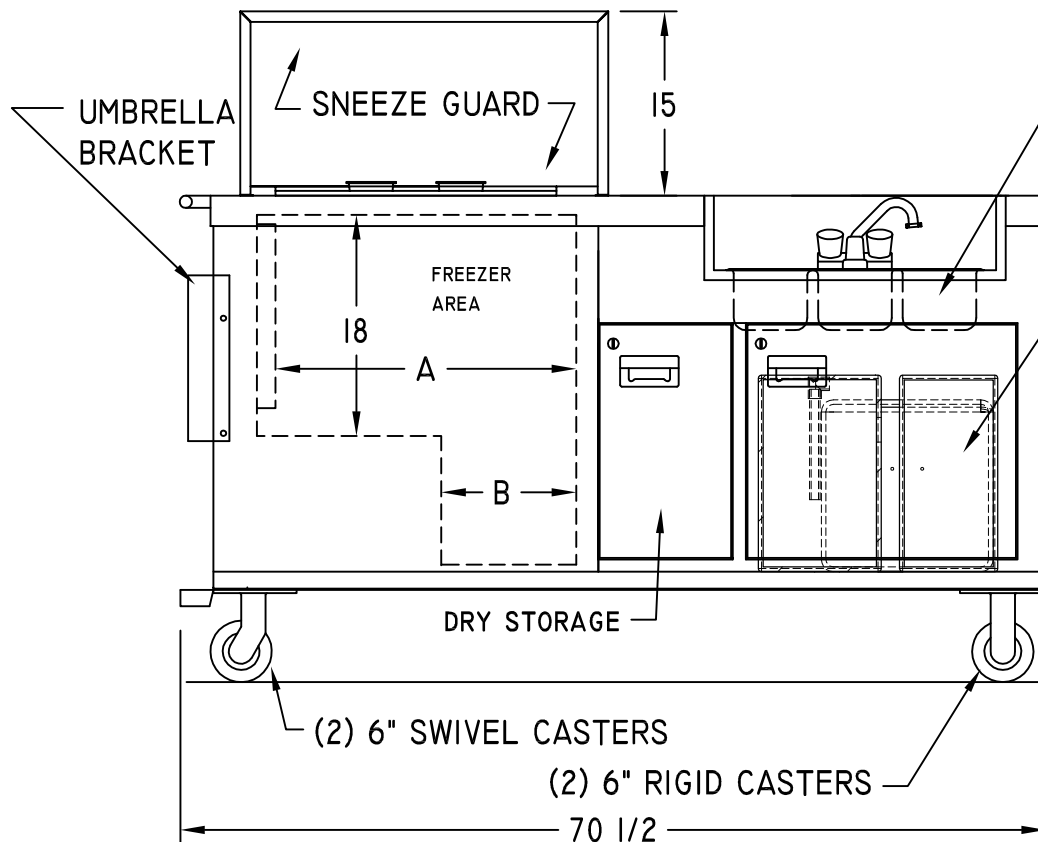

REV.			
C. NELSON MFG.			
TITLE: BD4CE WITH TRIPLE BOWL SINK			
USED ON: FINISHED GOODS			1 OF 1
DWN. BY: JED	PART NO.: BD4-CE-05		REV. NR
DATE: 04/17/08			
SCALE: AUTO			

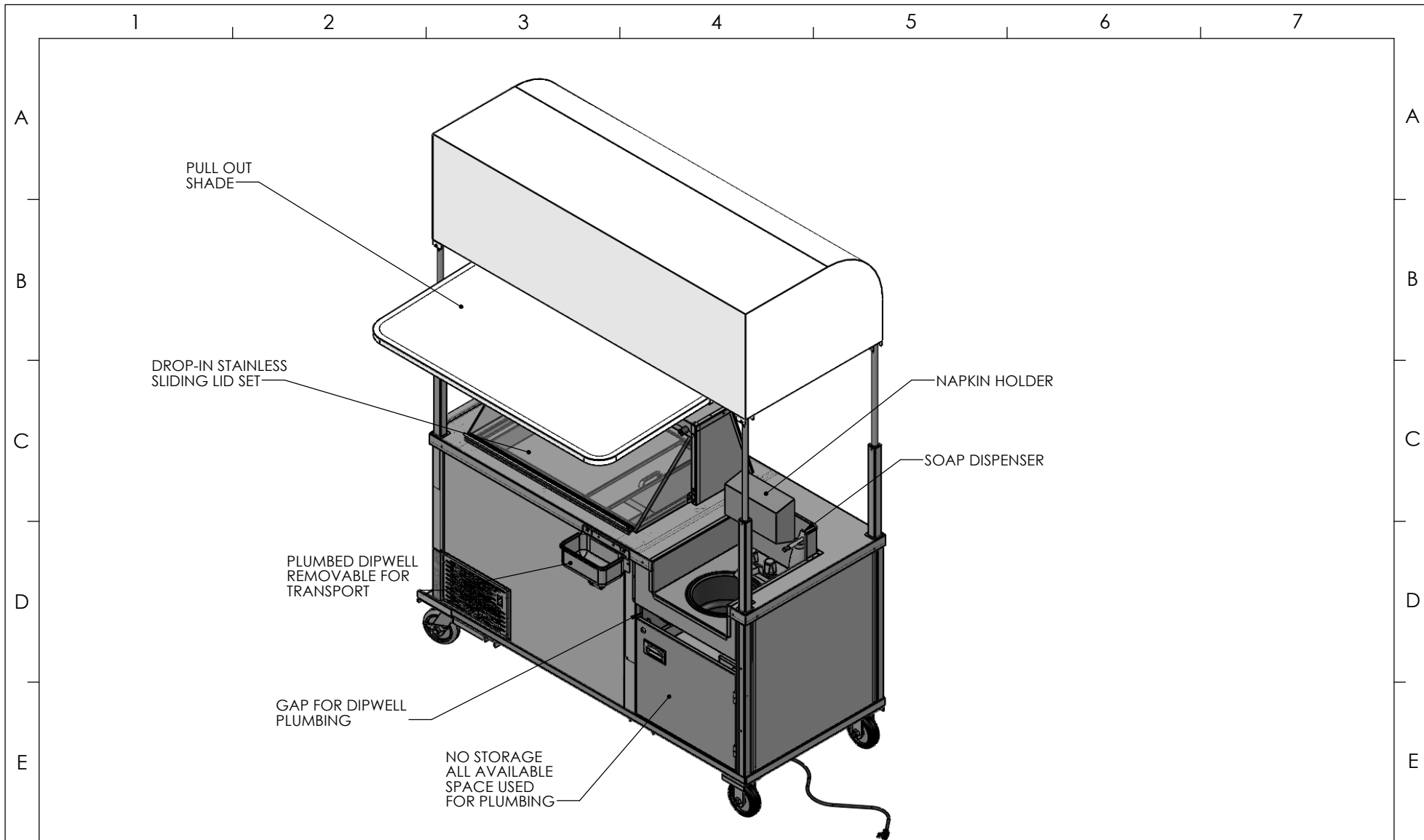

C. Nelson Mfg.

DWG. NO.
BD6CE-DIP-03-DW-HC

SIZE B	REV -	SHEET 1 OF 2	SCALE: 1:15
------------------	----------	--------------	-------------

TITLE:
**BD6CE-DIP-03 WITH
EXTERNAL DIPWELL**

	NAME	DATE	USED ON
DRAWN	PAC	11/10/21	
CHECKED			
COMMENTS: -			

PROPRIETARY AND CONFIDENTIAL

THE INFORMATION CONTAINED IN THIS DRAWING IS THE SOLE PROPERTY OF C. NELSON MFG. ANY REPRODUCTION IN PART OR AS A WHOLE WITHOUT THE WRITTEN PERMISSION OF C. NELSON MFG. IS PROHIBITED.

DO NOT SCALE DRAWING

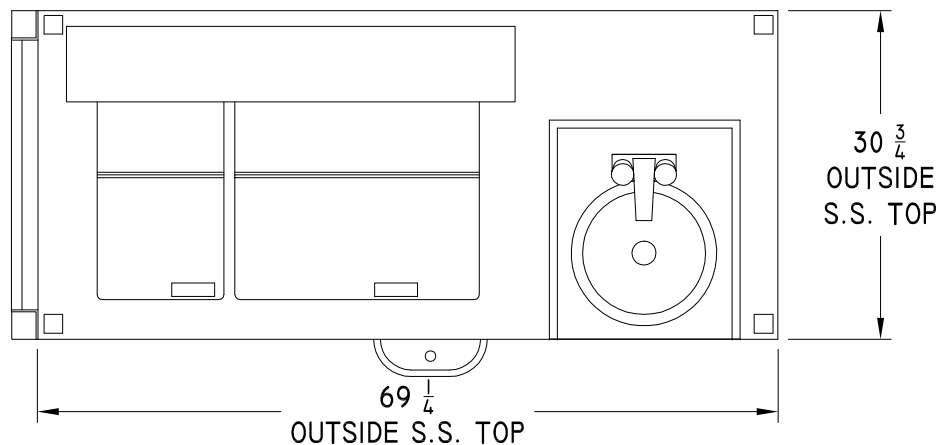

LABEL	DIM. WITH COLD PLATE	DIM. W/O COLD PLATE
A	36	39
B	22 $\frac{1}{2}$	24
C	22	25

MEETING HEALTH DEPARTMENT
REQUIREMENTS ARE THE
RESPONSIBILITY OF THE CUSTOMER

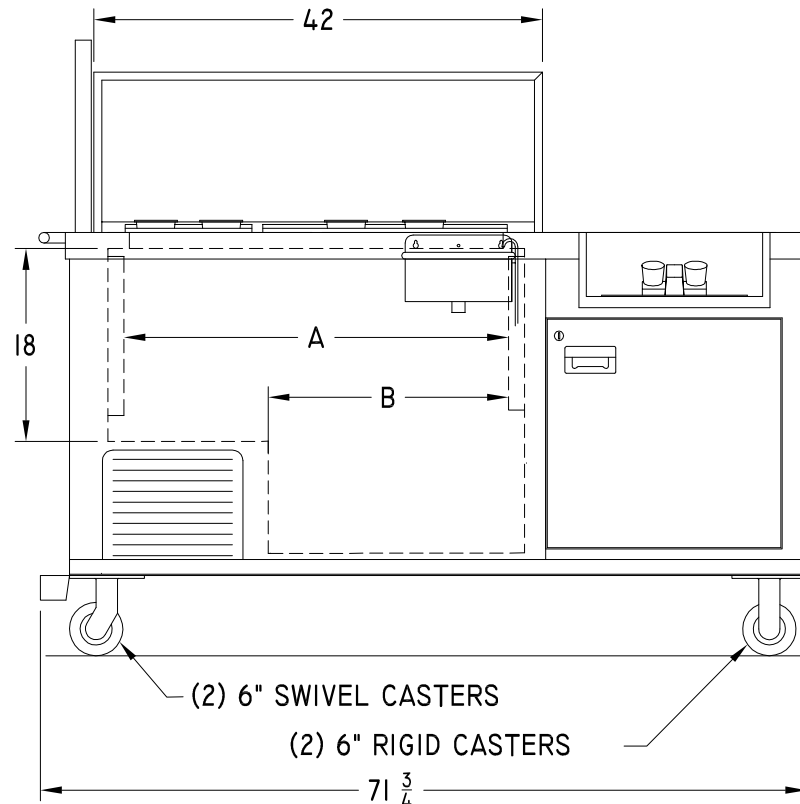

DIPPER
WELL

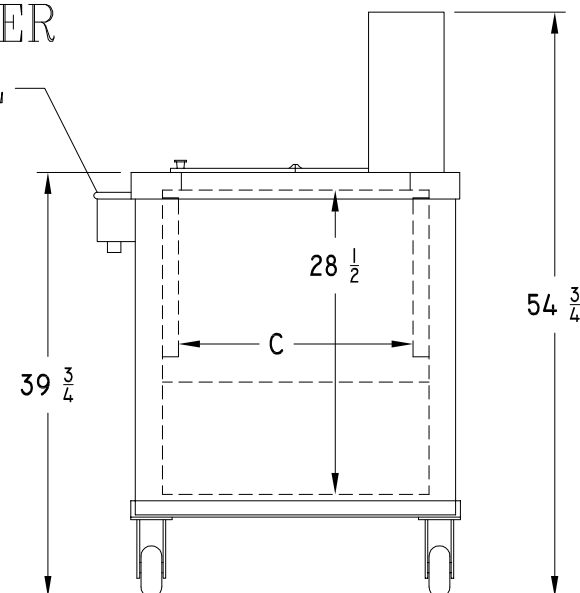

REV.		
C. NELSON MFG.		
TITLE: BD6-CE WITH SINK		
USED ON: FINISHED GOODS		1 OF 1
DWN. BY: JED	PART NO.: BD6-CE-03	REV. NR
DATE: 04/18/08		
SCALE: AUTO		

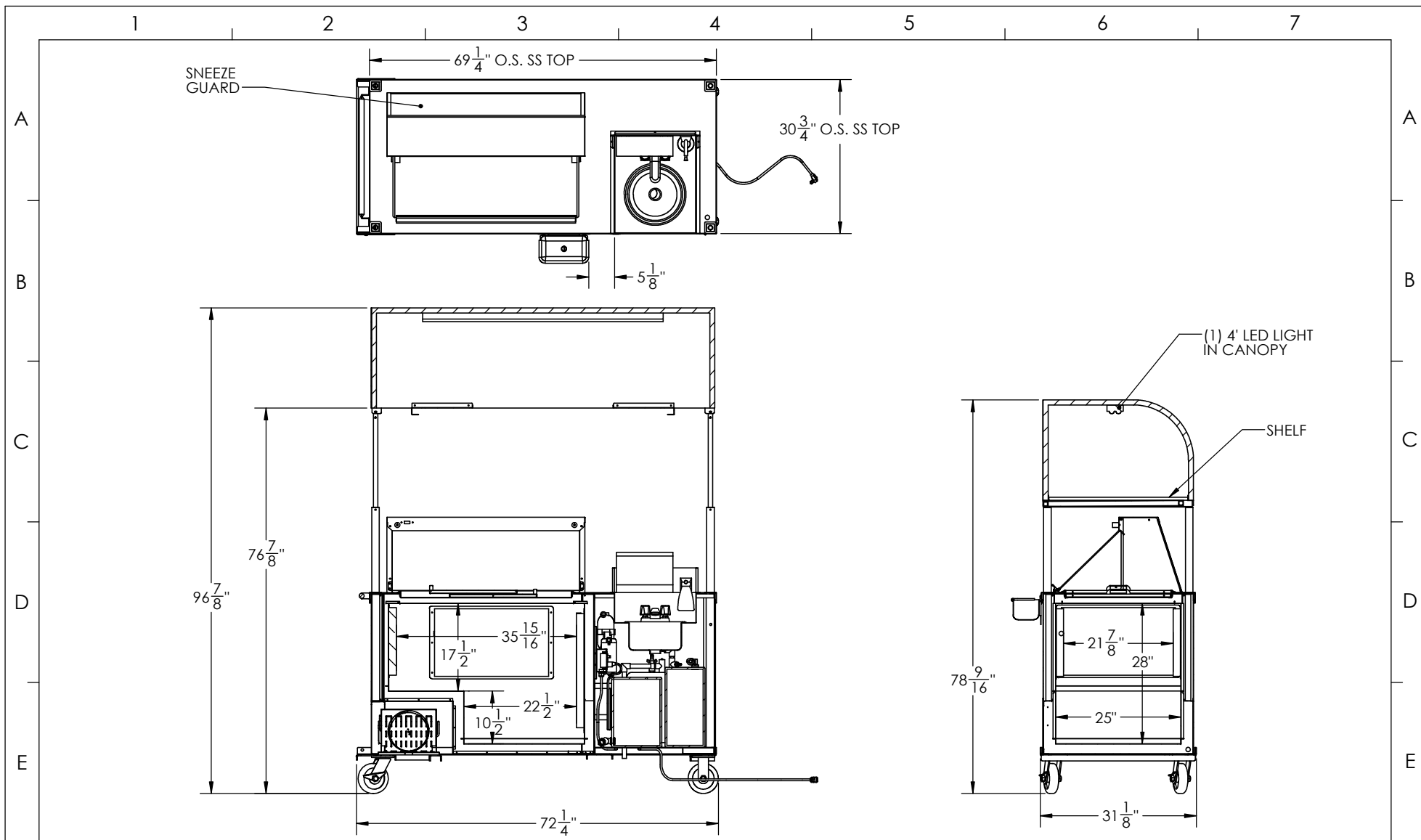

C. Nelson Mfg.

DWG. NO.
BD6CE-DIP-03-DW-HC

SIZE REV SHEET 2 OF 2 SCALE: 1:18

TITLE:
**BD6CE-DIP-03 WITH
EXTERNAL DIPWELL**

	NAME	DATE	USED ON
DRAWN	PAC	11/10/21	
CHECKED			
COMMENTS:			

-

PROPRIETARY AND CONFIDENTIAL
THE INFORMATION CONTAINED IN THIS DRAWING IS THE SOLE
PROPERTY OF C. NELSON MFG. ANY REPRODUCTION IN PART
OR AS A WHOLE WITHOUT THE WRITTEN PERMISSION OF C.
NELSON MFG. IS PROHIBITED.

DO NOT SCALE DRAWING

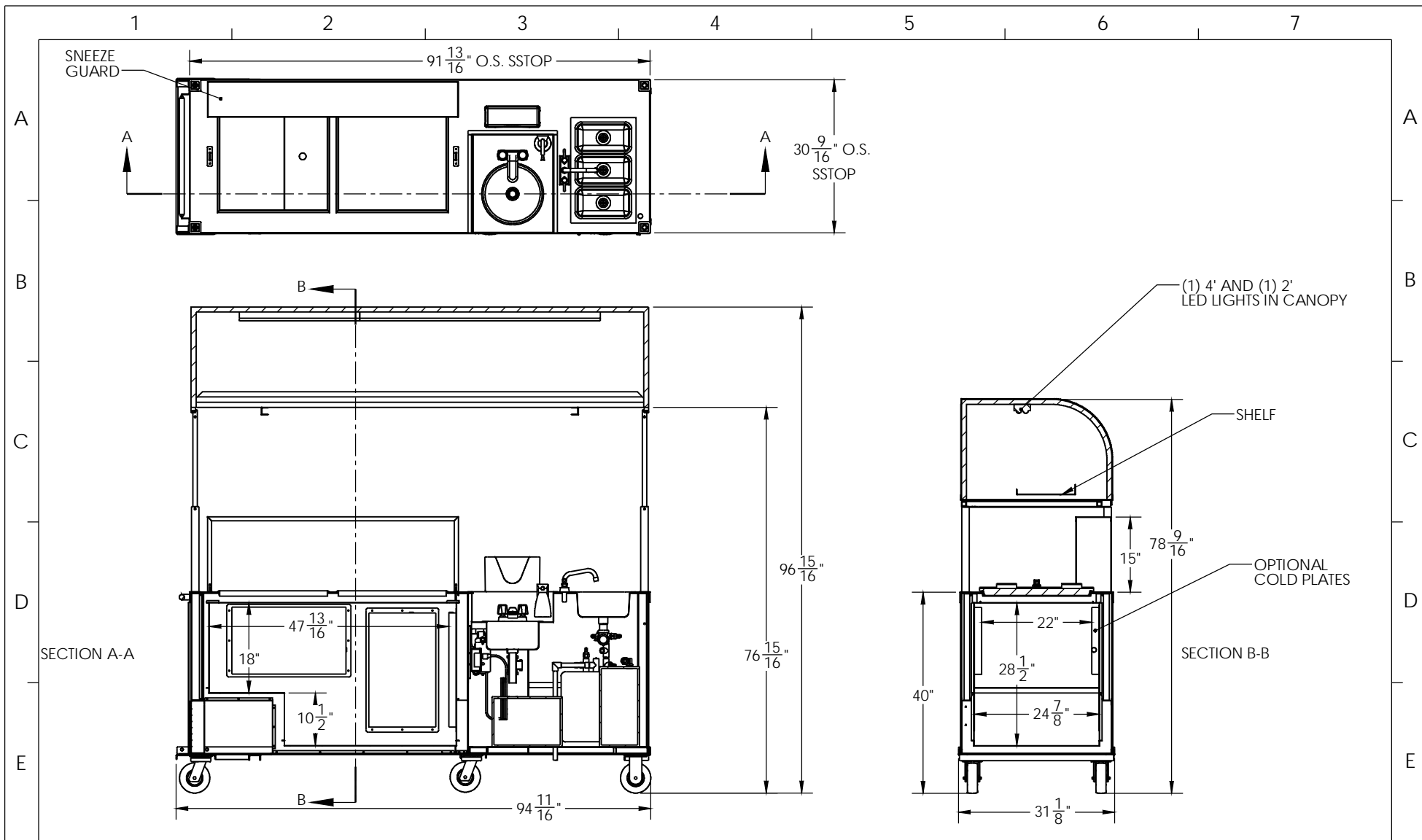

C. Nelson Mfg.

DWG. NO.
BD8CE-07

SIZE REV SHEET 2 OF 2 SCALE: 1:18

TITLE:

BD8CE-07

NAME	DATE	USED ON
DRAWN PAC	05/04/17	
CHECKED		
COMMENTS:		

-

PROPRIETARY AND CONFIDENTIAL

THE INFORMATION CONTAINED IN THIS DRAWING IS THE SOLE PROPERTY OF C. NELSON MFG. ANY REPRODUCTION IN PART OR AS A WHOLE WITHOUT THE WRITTEN PERMISSION OF C. NELSON MFG. IS PROHIBITED.

DO NOT SCALE DRAWING